

POLY HOPPER SPREADER COLLAR

INSTALLATION INSTRUCTIONS

1. Remove both lids from the hopper body by pulling out all D-ring pins and washers. Slide the lids back towards the chute and off the hopper body.
2. Remove the screens and screen supports from the hopper body.
3. Place the collar on top of the hopper body with the lid hinge posts in the same orientation on the collar as the hopper body.
4. Fit the collar tightly to the hopper body, minimizing all gaps.

⚠ CAUTION

Before drilling any holes, check both sides of the material for any wires, fuel lines, fuel tanks, etc. that may be damaged by drilling.

5. Drill a 3/8" clearance hole through the collar only, in-line with the lid hinge posts and about 1-1/2" above the bottom of the collar. Repeat at each lid hinge post location, for a total of six drilled holes.

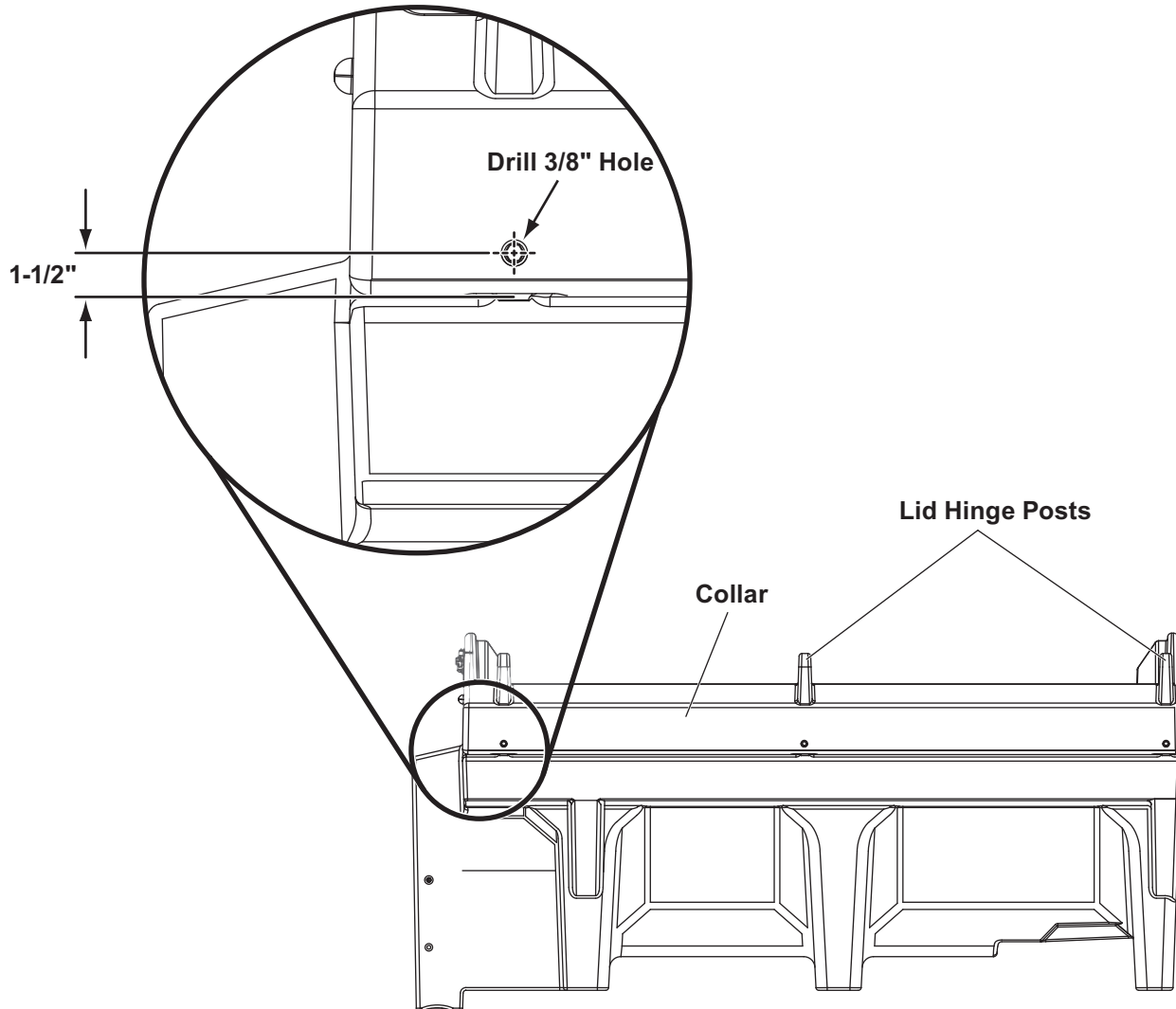

POLY HOPPER SPREADER COLLAR

- Secure using the supplied lag bolts with the lock washers between the flat washers and head of the bolts. The lag bolts should go through the collar and into the hopper body.
- Attach the lids to the collar by sliding them into place and inserting the large washers onto the lid hinge pins. Insert the D-ring pins into the holes on the lid hinge pins.

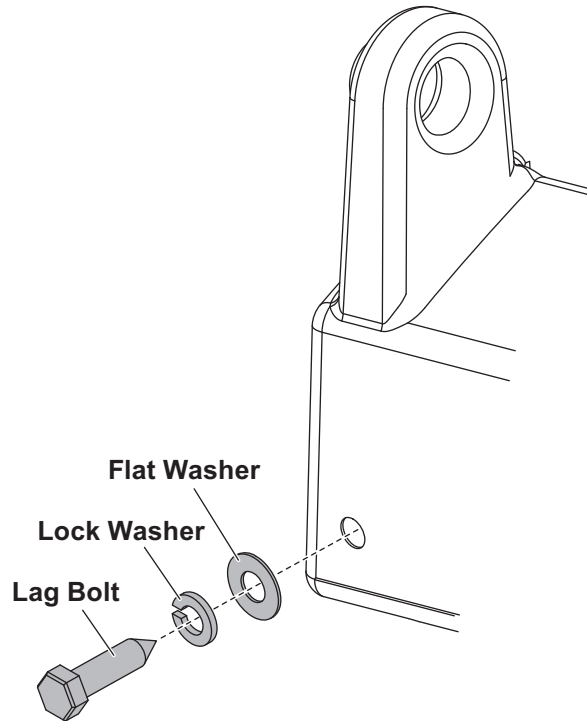

The company reserves the right under its product improvement policy to change construction or design details and furnish equipment when so altered without reference to illustrations or specifications used. This equipment manufacturer or the vehicle manufacturer may require or recommend optional equipment for spreaders. Do not exceed vehicle ratings with a spreader. The company offers a limited warranty for all spreaders and accessories. See separately printed page for this important information.

Printed in U.S.A.